

© STRINGENT COPYRIGHT:
 This drawing has been produced for:
 Let Manager Ltd.
 and prepared for submission as part of any statutory
 Applications. It is not intended for use by any other person or
 for any other building project or purpose without prior
 permission from Toldfield Architects Ltd.

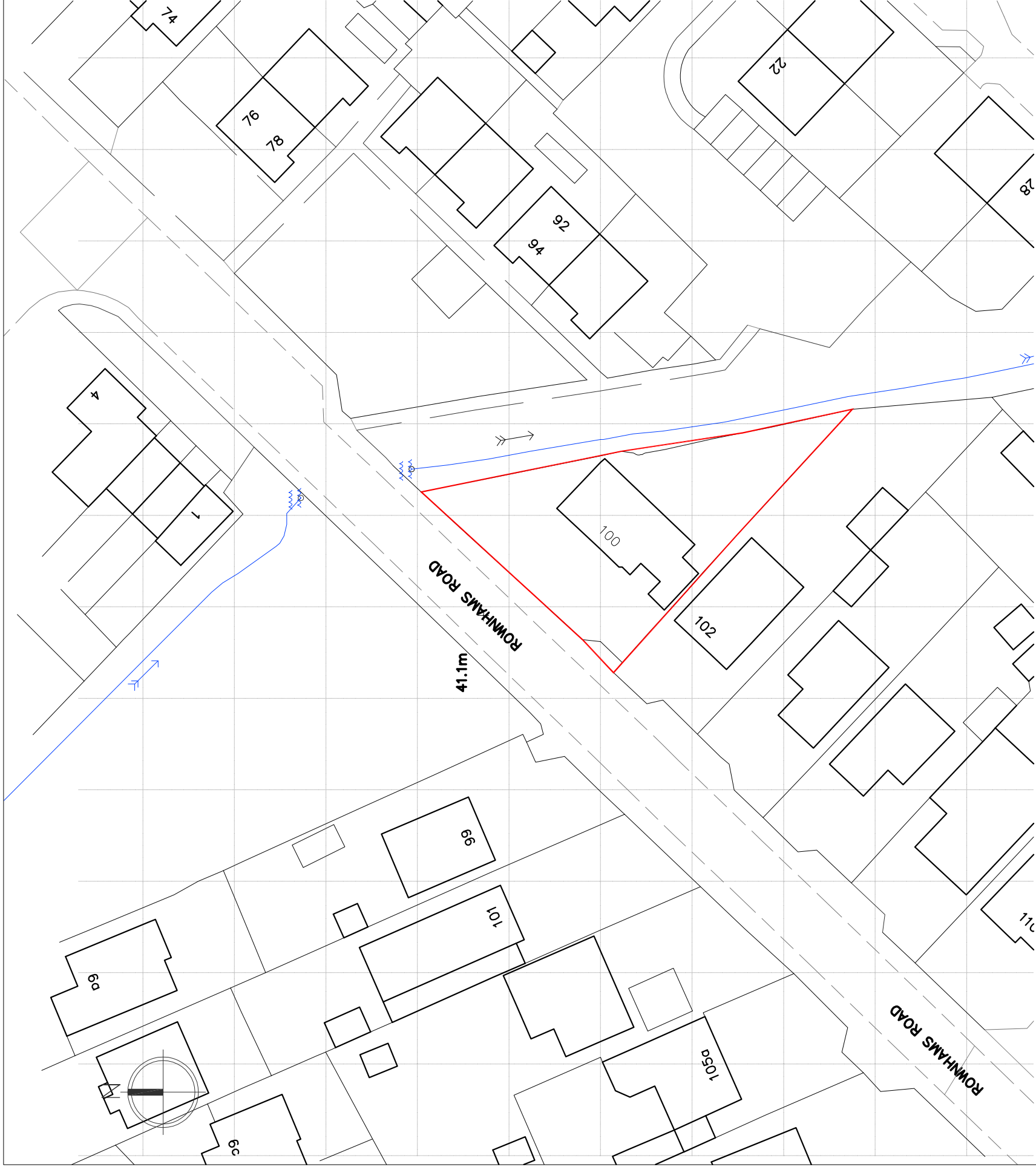
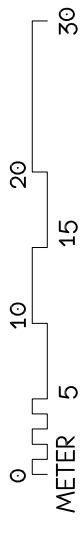
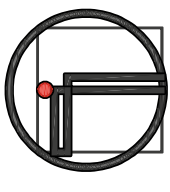

SITE LOCATION PLAN

1:500

TOLDFIELD ARCHITECTS
 Emails:
 info@toldfieldarchitects.co.uk
 adi@toldfieldarchitects.co.uk
 kourosh@toldfieldarchitects.co.uk
 Web: www.toldfieldarchitects.co.uk

Toldfield Architects Ltd
 5 Freemantle Business Centre
 152 Millbrook Road East
 Southampton
 SO15 1JR
 Tel: 023 80 236165

Project Name and Address:
Proposed new roof over existing dwelling flat roofs to form a larger 4-Bedroom dwelling @ 100 Rownhams Rd, N/ Baddesley

Client:
Let Manager ltd.

Drawing Title:
Location Plan

Project Ref:	201101	Origin:	TA - 01	Zone:	- 01	Level:	P	Type:	- A	Role:	- Po1 -	Number:		Rev:		
Status:	Appraisal															
TA Code:		Project Stage:											Sheet @ A3:		Date:	
	201101	Planning											1:500		Nov 2020	

Rev:		Comments:	
Dr:			
Ch:			